

## Magna-Lok®

The hole-filling fastener with mechanical circle lock and wide grip range.

The 360° solid-circle lock. It's Alcoa Fastening Systems and Rings' answer to loosening and vibration challenges. And it's the reason Magna-Lok® is the world's strongest, most reliable, most consistent blind fastening solution available. The unique locking design creates an internal lock during installation that virtually eliminates pin pushout by mechanically locking the pin to the sleeve. So Magna-Lok fasteners lock flush into place reliably. Permanently.

In lab shear fatigue tests, steel Magna-Lok fasteners outlasted the nearest competitor nearly 20 to 1. Ours lasted 2 million cycles, while theirs lasted only 100,000. In addition, this strength extends to the solid-circle lock design. The expanding sleeve creates a tough, long-lasting joint with a tight, weather-resistant seal. This shield blocks out water and salt, further ensuring the fastener's long, reliable life.

**Available Sizes:**

3/16", 1/4", 3/8", 1/2"

**Materials:**

Steel, Aluminum, Stainless Steel

**Headstyles:**

Protruding, Truss, 100° Flush

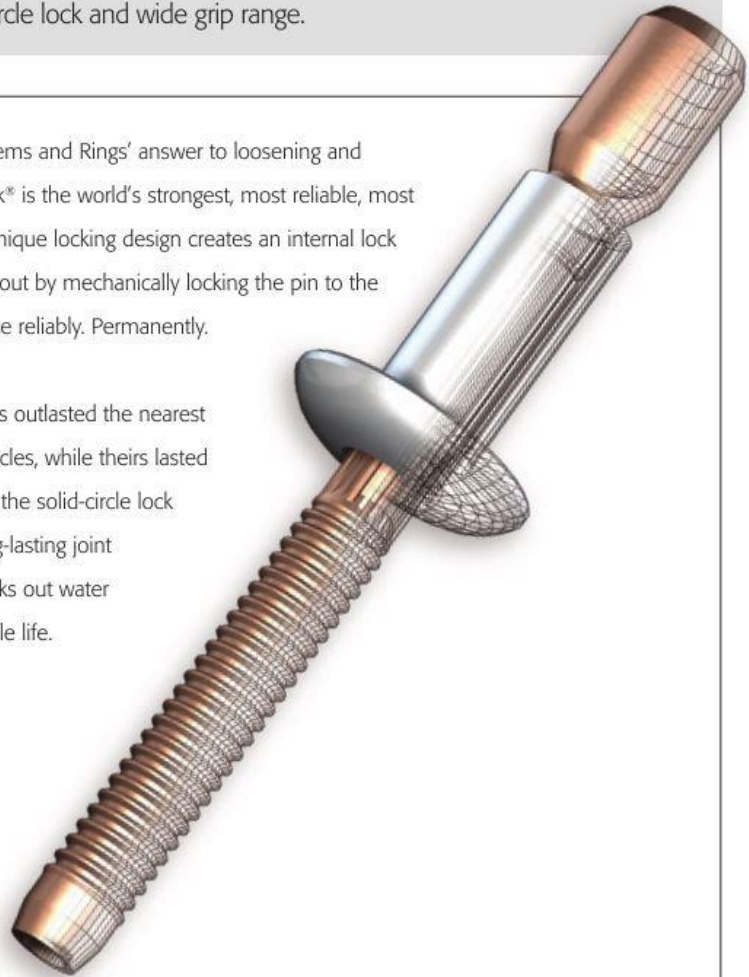

### Secure, Fast Installation

1. Flush pin break eliminates grinding and filling, leaving an even surface.
2. Unique, solid-circle lock ensures maximum strength and vibration resistance. The potential for pin push-out is virtually eliminated.
3. Excellent gap pull-out and high retained clamp.
4. Sleeve expands during installation to fill the hole and create a moisture-resistant joint.

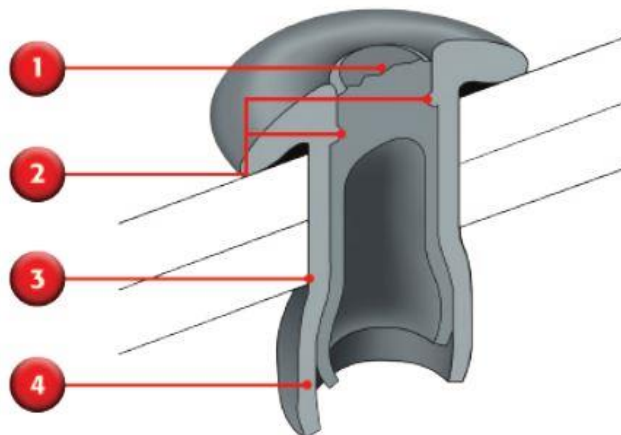



# STRUCTURAL FASTENERS

## MAGNA-LOK

BLIND FASTENER MADE IN THE USA

Data and Dimensions

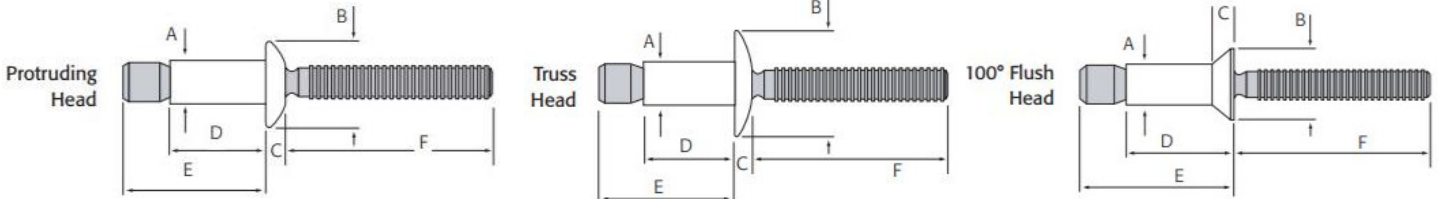

FASTENER CODE		A	B	DIA INCH	MM	DRILL SIZE	TYPICAL SHEAR (lbs)	INSTALLED VALUES TYPICAL(lbs)		GRIP RANGE MM	C	D	E	F
								TENSILE	PIN RET					
<b>PROTRUDING HEAD</b>														
<b>STEEL</b>														
MGLP-R6-4		4.78	9.78	3/16"	4.8	5.0	1450	1200	250	1.57 - 6.86	2.16	10.54	17.15	25.40
MGLP-R6-E		4.78	9.78	3/16"	4.8	5.0				1.57 - 11.10	2.16	14.53	24.13	25.40
MGLP-R8-6		6.43	13.34	1/4"	6.4	17/64	2750	2200	400	2.03 - 9.53	2.97	14.22	24.64	25.40
MGLP-R8-E		6.43	13.34	1/4"	6.4	17/64				2.03 - 15.88	2.97	20.57	35.69	25.40
MGLP-R8-E126		6.43	13.34	1/4"	6.4	17/64				6.22 - 20.00	2.97	24.76	39.87	25.40
MGLP-R8-18		6.43	13.34	1/4"	6.4	17/64				21.08 - 28.75	2.97	33.27	43.68	25.40
MGLP-R12-12		9.8	19.99	3/8"	9.5	10.0	6300	5000	1000	3.05 - 14.22	4.45	21.34	41.91	39.24
MGLP-R12-18		9.8	19.99	3/8"	9.5	10.0				15.8 - 28.57	4.45	35.80	53.30	39.24
<b>ALUMINIUM</b>														
MGLP-B6-E		4.78	9.78	3/16"	4.8	5.0	700	580	150	1.57 - 11.10	2.16	14.53	24.13	25.40
MGLP-B8-6		6.43	13.34	1/4"	6.4	17/64	1300	950	220	2.03 - 9.53	2.97	14.22	24.64	25.40
MGLP-B8-E		6.43	13.34	1/4"	6.4	17/64				2.03 - 15.88	2.97	20.57	35.69	25.40
MGLP-B12-12		9.8	19.99	3/8"	9.5	10.0	3000	2100	450	3.05 - 14.22	4.45	21.34	41.91	39.24
<b>STAINLESS STEEL</b>														
MGLP-U6-4		4.78	9.78	3/16"	4.8	5.0	1400	1100	125	1.57 - 6.86	2.16	10.54	17.15	25.40
MGLP-U6-7		4.78	9.78	3/16"	4.8	5.0				5.44 - 11.10	2.16	14.53	20.96	25.40
MGLP-U8-6		6.43	13.34	1/4"	6.4	17/64	2500	2000	250	2.03 - 9.53	2.97	14.22	24.64	25.40
MGLP-U8-10		6.43	13.34	1/4"	6.4	17/64				8.89 - 15.88	2.97	20.57	30.99	25.40
<b>TRUSS HEAD</b>														
<b>STEEL</b>														
MGLT-R6-4		4.75	12.7	3/16"	4.8	5.0	1450	1200	250	1.57 - 6.86	2.16	10.54	17.15	25.40
MGLT-R6-E		4.75	12.7	3/16"	4.8	5.0				1.57 - 11.10	2.16	14.53	24.13	25.40
<b>100° COUNTERSUNK HEAD</b>														
<b>STEEL</b>														
MGL100-R6-6		4.78	8.76	3/16"	4.8	5.0	1450	1200	250	3.18 - 8.41	1.78	12.34	19.35	25.40
MGL100-R8-8		6.53	10.29	1/4"	6.4	17/64	2750	2200	400	4.06 - 12.07	2.01	16.76	26.90	25.40
MGL100-R8-12		6.53	10.29	1/4"	6.4	17/64				10.54 - 18.42	2.01	23.11	33.25	25.40
MGL100-R12-12		9.8	16.05	3/8"	9.5	10.0	6300	5000	1000	6.09 - 19.05	3.40	26.16	42.21	38.93
<b>ALUMINIUM</b>														
MGL100-B6-6		4.78	8.76	3/16"	4.8	5.0	700	580	150	3.18 - 8.41	1.78	12.34	19.35	25.40
MGL100-B8-8		6.53	10.29	1/4"	6.4	17/64	1300	950	220	4.06 - 12.07	2.01	16.76	26.90	25.40
MGL100-B8-12		6.53	10.29	1/4"	6.4	17/64				10.54 - 18.42	2.01	23.11	33.25	25.40
<b>STAINLESS STEEL</b>														
MGL100-U8-8		6.53	10.29	1/4"	6.4	17/64	2500	2000	250	4.06 - 12.07	2.01	16.76	26.90	25.40



## Magna-Grip®

Offering a wide grip range and uniform installed values.

In applications where a wide grip range is required and a flush pin break to the collar is beneficial, Huck Magna-Grip® is the ideal fastener for the job. In fact, Magna-Grip's wide grip range can replace up to 4 traditional HuckBolts.

Like all Huck engineered fasteners, Magna-Grip offers the highest level of vibration resistance possible. Magna-Grip installs reliably, and consistently provides high, uniform installed values.

**Available Sizes:**

3/16", 1/4", 5/16", 3/8"

**Materials:**

Steel, Aluminum

**Headstyles:**

Button, Truss, Broad Truss, 90° Flush, 98T



### Secure, Fast Installation

1. Flush-breaking, lock-groove design provides a wide grip range to reduce inventory requirements.
2. Collar material swaged into the annular pin grooves forms a permanent, vibration-proof connection that promotes increased customer satisfaction and reduced warranty claims.
3. Hole preparation isn't critical. Built-in system values yield high, consistent clamp loads, and gap removal.

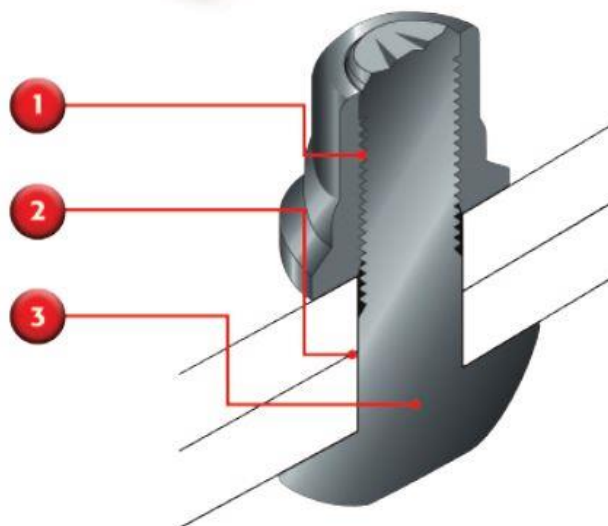



# STRUCTURAL FASTENERS

## MAGNA-GRIP LOCKBOLT

MADE IN THE USA

Fastener Specifications and Grip Data

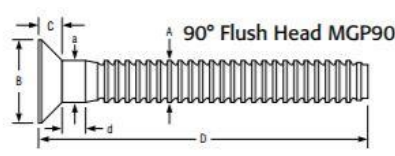
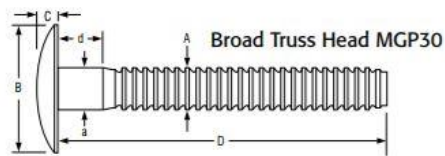
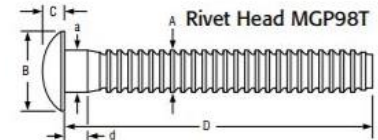
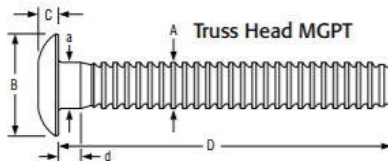
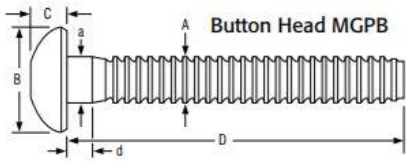

FASTENER CODE	A	B	DIA		DRILL SIZE	TYPICAL SHEAR (lbs)	INSTALLED VALUES			GRIP RANGE MM	C	D	a Ref	d Ref
			INCH	MM			TYPICAL (lbs)	TENSILE	CLAMP					
<b>Button Head - MGPB</b>														
<b>STEEL</b>														
MGPB-R6-10G	4.6-4.7	9.04-10.0	3/16"	4.8	13/64	2000	2700	1500	1.57 - 15.88	2.87-3.18	45.42	4.8-4.9	2.6-3.1	
MGPB-R6-20G									7.92 - 31.75		60.20		7.7-8.1	
MGPB-R8-10G	6.2-6.3	12.0-13.3	1/4"	6.4	17/64	2700	4000	2000	1.57 - 15.88	3.45-3.86	49.91	6.3-6.5	2.7-3.5	
MGPB-R8-20G									7.92 - 31.75		65.02		7.4-8.3	
MGPB-R10-12G	7.8-7.9	15.0-16.6	5/16"	7.9	8.0	3900	6200	2900	3.18 - 19.05	4.60-5.11	59.44	6.9-7.1	6.38Max	
MGPB-R10-22G									15.87 - 34.92		72.14	8.05-8.18	14.2-15.0	
MGPB-R12-14G	9.3-9.5	18.1-19.9	3/8"	9.5	25/64	6000	9000	4000	3.18 - 22.23	5.66-6.30	73.03	9.6-9.8	4.3-5.1	
MGPB-R12-26G									20.62 - 41.28		88.90		20.1-20.9	
<b>ALUMINIUM</b>														
MGPB-E8-10	6.2-6.3	12.0-13.3	1/4"	6.4	17/64	1600	2500	1400	1.57 - 15.88	3.45-3.86	49.91	6.3-6.5	2.7-3.5	
MGPB-E12-14	9.3-9.5	18.1-19.9	3/8"	9.5	25/64	3900	5500	3200	3.18 - 22.23	5.66-6.30	73.03	9.6-9.7	4.3-5.1	
<b>Truss Head - MGPT</b>														
<b>STEEL</b>														
MGPT-R8-10G	6.2-6.3	13.4-15.0	1/4"	6.4	17/64	2700	4000	2000	1.57 - 15.88	2.62 - 2.92	49.91	6.3-6.5	2.7-3.5	
MGPT-R8-20G									7.92 - 31.75		65.02		7.4-8.3	
MGPT-R8-32G									26.97 - 50.80		85.70		7.4-8.3	
<b>Broad Truss Head - MGP30</b>														
<b>STEEL</b>														
MGP30-R8-10G	6.2-6.3	23.8	1/4"	6.4	17/64	2700	4000	2000	3.96 - 15.88	3.51 - 4.11	49.91	6.3-6.5	2.7-3.5	
MGP30-R8-24G									15.88 - 38.1		71.37		13.8-14.6	
MGP30-R12-24G	9.3-9.5	30.1-31.7	3/8"	9.5	25.64	6000	9000	4000	15.88 - 38.1	4.78 - 5.38	85.73	9.6-9.7	16.8-17.6	
<b>Rivet Head - MGP98T</b>														
<b>STEEL</b>														
MGP98T-R6-10G	4.6-4.7	11.43-12.40	3/16"	4.8	13/64	2000	2700	1500	1.57 - 15.88	2.31-2.67	45.42	4.8-4.9	1.9-2.4	
MGP98T-R6-20G									7.92 - 31.75		60.20		7.7-8.1	
<b>ALUMINIUM</b>														
MGP98T-E6-10G	4.6-4.7	11.43-12.40	3/16"	4.8	13/64	1000	1300	800	1.57 - 15.88	2.31-2.67	45.42	4.8-4.9	1.9-2.4	
MGP98T-E6-20G									7.92 - 31.75		60.20		7.7-8.1	
<b>90° Countersunk Head - MGP90</b>														
<b>STEEL</b>														
MGP90-R6-10G	4.6-4.7	8.20-9.12	3/16"	4.8	13/64	2000	2700	1500	1.57 - 15.88	2.34-2.59	45.42	4.8-4.9	8.9 Max	
MGP90-R8-10G	6.2-6.3	11.43-12.40	1/4"	6.4	17/64	2700	4000	2000	1.57 - 15.88	3.02-3.25	49.91	5.5-5.7	9.6 Max	
<b>ALUMINIUM</b>														
MGP90-E6-10	4.6-4.7	8.20-9.12	3/16"	4.8	13/64	1000	1300	800	1.57 - 15.88	2.34-2.59	45.42	4.8-4.9	8.9 Max	



## STRUCTURAL FASTENERS

### MAGNA-GRIP COLLARS

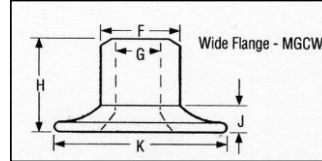
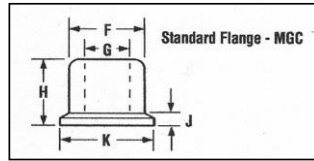

COLLAR CODE	COLLAR TYPE	MATERIAL	DIA INCH	F	G	H	J	K
MGC-R6U	Standard	STEEL	3/16"	7.85 - 7.92	4.83-4.93	6.86 - 7.11	1.07 - 1.27	9.35 - 9.70
MGC-F6	Standard	ALUM	3/16"	7.85 - 7.92	4.83-4.93	6.86 - 7.11	1.07 - 1.27	9.35 - 9.70
MGCW-R6U	Wide	STEEL	3/16"	7.80 - 7.98	4.67-5.00	7.82 - 9.09	1.98 - 2.97	16.26 - 19.38
MGCW-F6	Wide	ALUM	3/16"	7.80 - 7.98	4.67-5.00	7.82 - 9.09	1.98 - 2.97	16.26 - 19.38
MGC-R8U	Standard	STEEL	1/4"	10.24-10.31	6.40-6.48	9.40 - 9.65	1.45 - 1.70	12.45 - 12.95
MGCW-R8U	Wide	STEEL	1/4"	10.24-10.41	6.40-6.48	10.97 - 11.73	2.92 - 3.68	21.72 - 25.40
MGC-F8	Standard	ALUM	1/4"	10.24-10.31	6.40-6.48	9.40 - 9.65	1.45 - 1.70	12.45 - 12.95
MGC-R10U	Standard	STEEL	5/16"	12.78-12.88	7.98-8.08	10.97 - 11.28	1.80 - 2.13	15.54 - 16.18
MGC-R12U	Standard	STEEL	3/8"	15.37-15.47	9.60-9.70	12.70 - 12.95	2.24 - 2.49	18.80 - 19.30
MGC-F12	Standard	ALUM	3/8"	15.37-15.47	9.60-9.70	12.70 - 12.95	2.24 - 2.49	18.80 - 19.30

### HUCK INSTALLATION TOOL - LH224

CAN INSTALL THE FOLLOWING FASTENERS WITH CORRECT NOSE ASSEMBLY

TYPE	DIAMETER	NOSE ASSEMBLY CODE
MAGNA-LOK	3/16"	99-3300
	1/4"	99-3301
	3/16" & 1/4"	99-3487A
MAGNA-BULB	3/16"	99-3300
	1/4"	99-3301
MAGNA-GRIP	3/16"	99-3201
	1/4"	99-3204
HUCKTAINER	3/8"	99-3465
C6L HUCKBOLTS	3/16"	99-3003
	1/4"	99-3006



### HUCK INSTALLATION TOOL - 256

CAN INSTALL THE FOLLOWING FASTENERS WITH CORRECT NOSE ASSEMBLY

TYPE	DIAMETER	NOSE ASSEMBLY CODE
MAGNA-LOK	3/8"	99-3318
MAGNA-GRIP	5/16"	99-1439
	3/8"	99-1440
BOM	3/16"	99-1053
	1/4"	99-830-1
	5/16"	99-769
C6L HUCKBOLTS	5/16"	99-2558
	1/4"	99-2564





## HuckLok®

Wide grip-range and double-locking action for a secure hold.

Featuring a wide grip range and unique double-locking action, the HuckLok® blind rivet combines high shear strength and high pull-up force. Its double-locking action consistently secures the assembly from both sides, resulting in maximum hold and joint integrity. Its large, blind-side footprint prevents pull-through, especially when joining thin or lightweight materials, such as plastics, composites, or any kind of pliable material. Positive mechanical pin retention ensures structural integrity, while annular grooves keep pressure on the back side.

- Available Sizes:**  
3/16", 1/4"
- Materials:**  
Steel
- Headstyles:**  
Protruding, Truss, 100° Oval Flush

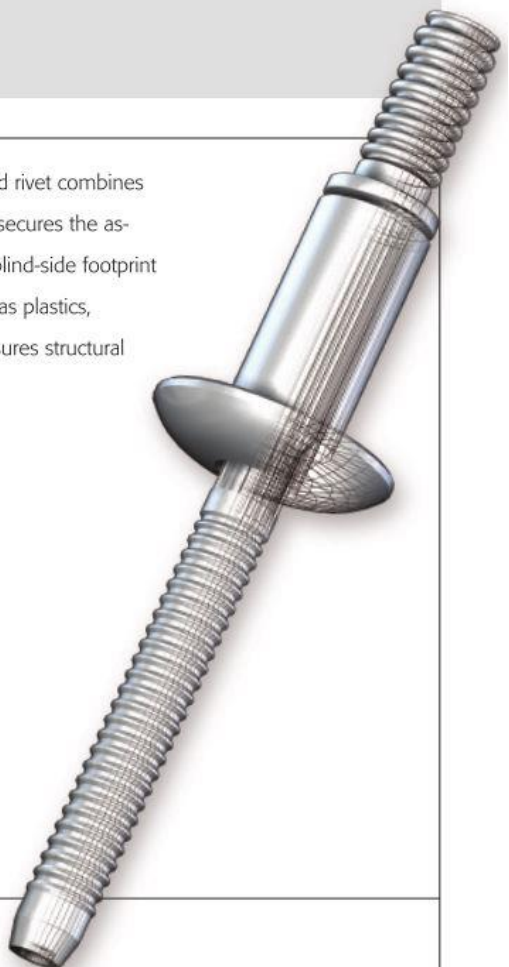
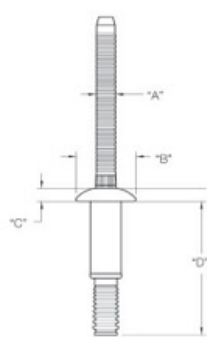

### Secure, Fast Installation

1. Breaking flush throughout its grip range, HuckLok allows at-a-glance verification of installation accuracy.
2. Undercut fillet allows seating in burred holes.
3. Solid pin provides exceptionally high strength in the shear plane.
4. Lock groove on pin engages shoulder on rivet head, while the extruded support ring "double locks" the pin within the bulb.

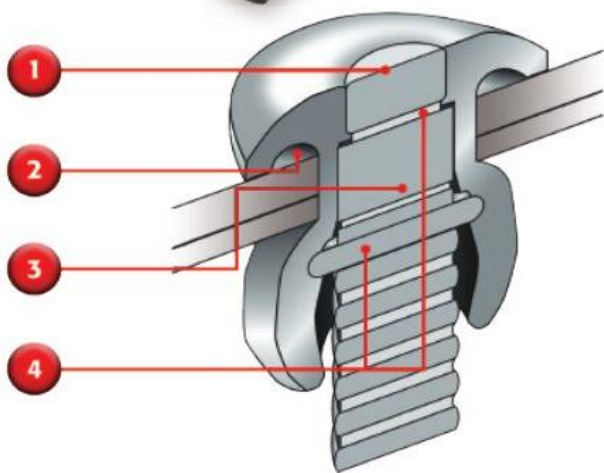

FASTENER CODE	A	B	DIA		DRILL SIZE	TYPICAL SHEAR (lbs)	INSTALLED VALUES		GRIP RANGE MM	C	D
			INCH	MM			MINIMUM TENSILE (lbs)				
<b>PROTRUDING HEAD STEEL</b>											
HKLP-R8-6	6.4	11.9	1/4"	6.4	17/64	3500	1900		2.00 - 9.50	3.00	28.30
HKLP-R8-7									4.80 - 11.10		29.90

### Magna-Bulb®

A unique bulbing fastener with high shear strength.

Huck Magna-Bulb® is a unique, clamp-type fastener offering high shear strength in specific applications. Its bulbing action during installation spreads the load over more surface area, supplying a stronger, longer-lasting connection, while offering superior blind side strength. This increased bearing area makes Magna-Bulb ideal for pull-out resistance in thin materials, and oversized or misaligned holes. Positive, mechanical pin-retention ensures structural integrity no matter what the application.

**Available Sizes:**

3/16", 1/4", 5/16"

**Materials:**

Steel

**Headstyles:**

Protruding, Truss, 100° Oval Flush



### Secure, Fast Installation

1. Shear ring design promotes bulb formation and grip adjustment for flush break throughout the grip range.
2. The wide blind footprint (bulb) gives the fastener a broader bearing surface, spreading the load out for greater strength and high pull out resistance.
3. Unique solid circle lock ensures maximum strength and resistance to vibration.
4. Breaking flush throughout the entire grip range, the Magna-Bulb fastener eliminates costly cosmetic finish work and ensures "visually" that the fastener has been installed correctly.

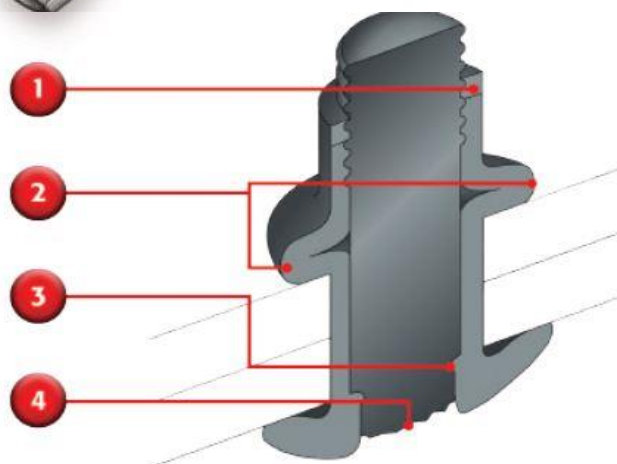



**MAGNA-BULB STEEL**

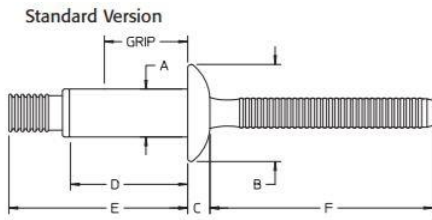

FASTENER CODE	GRIP		DIA INCH MM	DRILL SIZE	TYPICAL SHEAR (lbs)	INSTALLED VALUES		GRIP RANGE MM	C	D	E	F
	A	B				TYPICAL (lbs)	TENSILE					
MBP-R8-M4	6.38	13.46	1/4" 6.4	17/64	2760	2000	3.81 - 5.82	3.18	13.77	23.19	27.94	
MBP-R8-M5					3000	2000	4.80 - 6.81		14.76	23.88		
MBP-R8-M6					3200	2000	5.82 - 7.82		15.77	25.40		
MBP-R8-M7					3600	2000	6.81 - 8.79		16.76	26.42		
MBP-R8-M8					3600	2000	7.82 - 9.83		17.78	27.43		
MBP-R8-M9					3600	2000	8.79 - 10.80		18.77	28.45		
MBP-R8-M10					3600	2000	9.83 - 11.84		19.79	29.46		
MBP-R8-M11					3600	2000	10.80 - 12.80		20.78	30.48		

**HUCKTAINER LOCKBOLT**

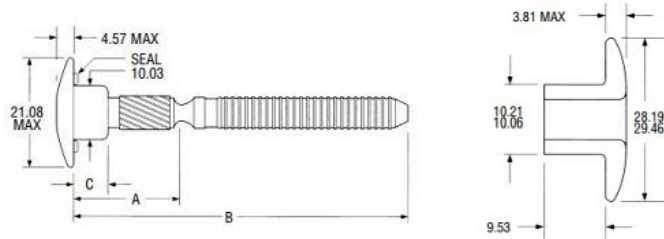

A fastener specifically designed for the commercial vehicle body building industry where G.R.P (glass reinforced plastic) boards are used. This fastener covers a wide grip range, is T.I.R approved, gives improved security to commercial vehicles and has excellent cosmetic appearance qualities. It is T.I.R approved, gives improved security to commercial vehicles and has excellent cosmetic appearance qualities.

**HUCKTAINER PIN LOW PROFILE - STEEL**

**HUCKTAINER COLLAR WIDE BEARING - STEEL**

FASTENER CODE	GRIP		DIA MM	DRILL SIZE	C	GRIP RANGE MM
	A	B				
HLPP-R12-10	15.85	56.69	10.03	10.5	2.54	14.27 - 17.48
HLPP-R12-12	19.02	59.87	10.03	10.5	5.59	17.45 - 20.62
HLPP-R12-14	22.20	63.04	10.03	10.5	8.76	20.62 - 23.80
HLPP-R12-16	25.37	66.22	10.03	10.5	11.94	23.80 - 26.97
HLPP-R12-18	28.55	69.39	10.03	10.5	15.11	26.97 - 30.15
HLPP-R12-20	31.72	72.57	10.03	10.5	18.29	30.15 - 33.32

COLLAR	
<b>HLPS-R12</b>	

**Huck Tools**

The industry's best installation tooling.



Designed to offer the highest levels of ergonomics, productivity, and long life, the Huck line of installation tooling reflects the same level of innovation and quality as its advanced fasteners. Whether it's a Huck hydraulic tool employed in high-volume installation of large diameter HuckBolts, or a smaller pneumatic model used to install blind rivets and small diameter HuckBolts, you can count on these tools to deliver the industry's best value.



**2480**  
The Model 2480 is a very lightweight tool which provides for the high-speed installation of a wide range of HuckBolt and Huck blind bolt fasteners. The tool has only one moving part, resulting in outstanding reliability and minimal maintenance. The tight centerline-to-edge measurement of the Model 2480 and its light weight (2.21 pounds) allow for its use in limited clearance areas.



**2581**  
The Model 2581 is a lightweight tool (only 6.58 pounds) designed for use in a wide range of high-speed production applications. With only one moving part, the tool provides for increased reliability and requires minimal maintenance. An offset piston design allows the Model 2581 to easily fit in limited clearance applications.





## HUCK TOOL SELECTION CHART



Fastener	Dia	Pneudraulic Installation Tool	Hydraulic Installation Tool	Nose Assembly	Powerig
<b>Magnalok</b>	3/16	LH-224	2480	99-3300	940-220AUS
	1/4	LH-224	2480	99-3301	940-220AUS
	3/8	256	2480	99-3318	940-220AUS
<b>Hucklok</b>	1/4	LH-224	2480	99-3301	940-220AUS
<b>Magnabulb</b>	1/4	LH-224	2480	99-3301	940-220AUS
<b>Bom</b>	3/16	LH-224	2480	99-994	940-220AUS
	1/4	256		99-830-1	
	5/16	256		99-769	
	3/8	256		99-1272	

### Two Piece Huck Bolts



Fastener	Dia	Pneudraulic Installation Tool	Hydraulic Installation Tool	Nose Assembly	Powerig
<b>Magnagrip</b>	3/16	LH-224	2480	99-3201	940-220AUS
	1/4	LH-224	2480	99-3204	940-220AUS
	5/16	256	2581	99-1439	940-220AUS
	3/8	256	2581	99-1440	940-220AUS
<b>C6L</b>	3/16	LH-224	2480	99-3003	940-220AUS
	1/4	LH-224	2480	99-3006	940-220AUS
<b>Hucktainer</b>	3/8	LH-224	2581	99-3465	940-220AUS

2480



2581



LH-224



256



#### Huck Powerig® Power Source 940-220AUS

The Model 940 Powerig® is a portable unit sized for moderate production and repair applications. This unit features rugged construction for durability in the field and the choice of 115 or 220 Volt AC power. The Model 940 includes a handle for easy transport, simple adjustable hydraulic outputs and quick couplers for connecting installation tool hoses.





## STRUCTURAL FASTENERS



### PANELOK

Panelok is a highly customised two-piece bolt-& nut type fastener. When installed, a high tensile, low profile splined bolt with an undercut head. Nitrile seal and Scotch-grip patch on the thread matches neatly with a Torx drive T-nut. Externally tamperproof, the assembly is optimal for Metal/wood applications where a Low-Profile finish is desirable on both-sides. Door hardware and frame/bulkhead attachments to GRP applications.

CODE	D1 DIA MM	HOLE SIZE MM	D2 Thread	SEAL COLOUR	STANDARD STRENGTH		HEAD DIAMETER H (mm)	HEAD THICKNESS W (mm)	L (mm)
					kn SHEAR	kn TENSILE			
Bolt									
APLB-1014	10.5	10.0	5/16" Unc	BLUE	14KN	20KN	22.0	5.0	22.2
APLB-1016	10.5	10.0	5/16" Unc	YELLOW			22.0	5.0	25.4
APLB-1020	10.5	10.0	5/16" Unc	RED			22.0	5.0	31.8

CODE	H MM	W MM	L MM	D MM	Drive Bit
Nut					
APLN-1008	25	5.0	13.0	10.0	Torx T55
APLN-1010	25	5.0	16.0	10.0	Torx T55
APLN-1016	25	5.0	25.0	10.0	Torx T55

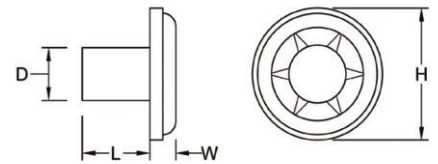

### GRIP DATA - Using various bolt/nut combinations

Bolt Code	Nut Code	Grip Range MM
APLB-1014	APLN-1008	21.0 - 24.9
APLB-1014	APLN-1010	22.5 - 28.1
APLB-1016	APLN-1008	24.4 - 28.1
APLB-1016	APLN-1010	25.4 - 31.3
APLB-1020	APLN-1008	30.8 - 34.5
APLB-1020	APLN-1010	30.8 - 37.7
APLB-1020	APLN-1016	35.3 - 47.6

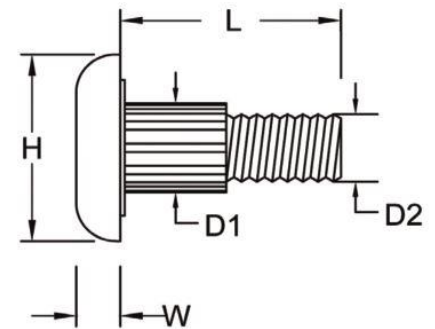



## Gesipa BULB-TITE Rivets

Bulb-Tite is the original load spreading rivet. During installation the body of the rivet folds into 3 separate legs which creates a large bearing surface and distributes the clamp force allowing soft or thin materials to be joined without damage. The mandrel of the rivet will break flush with the head over a wide grip range which results in impressive shear strength. BT Rivets are usually supplied with a neoprene washer under the head for a weather tight seal.

**Material:** Rivet: 5056 Aluminium    **Mandrel:** 2017 Aluminium  
Steel, zinc-plated (RV6676)

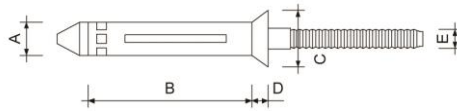
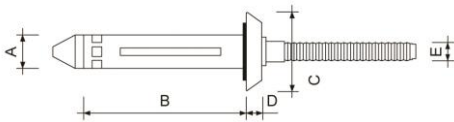

RIVET CODE	RIVET DIA A INCH	RIVET DIA A MM	DRILL SIZE	RIVET B LENGTH MAX MM	GRIP RANGE MM	STANDARD STRENGTH KN		HEAD DIAMETER C (mm)	HEAD THICKNESS D (mm)Max	PACK SIZE
						SHEAR	TENSILE			
<b>Aluminium Rivet / Aluminium Mandrel</b>										
<b>Countersunk Head</b>										
RV6601-6-6		5.2	5.3	22.7	4.7 - 9.5	2.7	2.0	8.6	2.6	3000
RV6601-6-8				25.9	7.9 - 12.7					3000
<b>Dome Head</b>										
RV6606-6-4W		5.2	5.3	19.6	1.6 - 6.4	2.7	2.0	11.3 - 12.5	2.5	3000
RV6606-6-6W				22.7	4.7 - 9.5					3000
RV6606-6-8W				25.9	7.9-12.7					3000
RV6606-6-12W				32.3	14.3-19.1					2000
RV6606-8-4W		6.3	6.4	20.7	1.0 - 6.4	4.2	2.5	13.6 - 14.0	2.9	2000
RV6606-8-6W				23.4	3.2-9.5					2000
RV6605-9-6W		7.7	8.0	28.2	1.1 - 9.5	6.7	4.9	18.3 - 19.4	3.8	1000
RV6605-9-10W				34.5	6.4 - 15.9					1000
RV6605-9-12W				37.7	9.5 - 19.1					1000
<b>Steel Rivet / Steel Mandrel</b>										
RV6676-8-6W		6.3	6.4	23.4	3.2 - 9.5	5.6	4.2	13.6 - 14.0	2.90	1500

